

# Wide use type *Blow Nozzle*

## Handling manual

● Please read this without fail before use.

- ◆ This time, thank you very much for purchasing the Blow nozzle.
- ◆ Please confirm whether the model, type, and the order article are not wrong by the name board.



### Attention on use

- 1 Please select and use after the performance of the blower and hot-air generator is grasped and considered sufficiently when the blow nozzle is used.
- 2 Please do not supply the fluid other than air or steam to the blow nozzle absolutely.
- 3 The blow nozzle is the precise product. Please handle prudently because the transformation and damage occurs by the impact. And, please pay attention to the fall sufficiently at the time of transport and setting.
- 4 Please consider the environment of the surroundings sufficiently when the hot-air is discharged. And, please perform the burn and environment by the establishment of the insulating material and cover
- 5 The heatproof temp. of the blow nozzle is 500 °C. Transformation and air leakage occurs by heat if the air more than 500 °C was supplied. And, there is the possibility that is connected to the important accident.
- 6 The resisting pressure of the blow nozzle is 0.1MPa. Explosion and air leakage occurs if the pressure more than 0.1MPa was supplied. And, there is the possibility that is connected to the important accident.
- 7 Economic using discharge air-speed is decided by the model, slit width, and slit length of the blow nozzle. Balance of air is disturbed more than the accuracy rating if the air-speed more than it was used.
- 8 O-ring and flange packing are used to the blow nozzle. Air leakage may occur because the deterioration becomes early if the blow nozzle is used high temp. at the long time. Please check the air leakage periodically.



# 1. Attachment

① Please attach the blow nozzle by the fixation metal fittings of the belonging. At this time, please fix the fixation nut for the loose bolt to the optional position after the openings more than 3mm is secured between the loose bolt for the top side fixation metal fittings and the nut of the top of the blow nozzle. (To absorb the expansion and contraction of the blow nozzle by the thermal expansion.)

\* Slit may explode by the thermal expansion if air is supplied to the blow nozzle without securing the opening more than 3mm.

② Please adjust the height as occasion demands. Please adjust to the optional height after loosening the fixation nut for a top side loose bolt and fixation screw for the air supply inlet side fixation metal fittings.

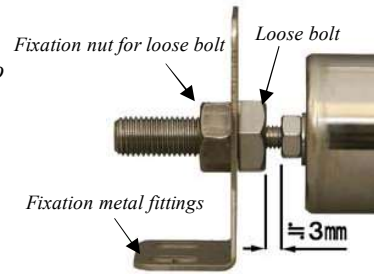

Top side



Air supply inlet side

③ Please adjust the discharge angle of the slit as occasion demands.

The discharge angle of the slit (with the attachment screw) can be adjusted optionally by attaching the angle adjustment metal fittings of the belonging. Please attach the angle adjustment metal fittings in accordance with the following procedure.

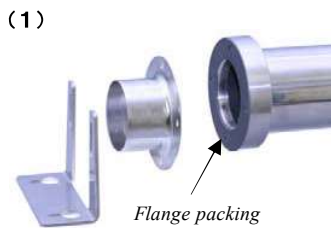

· Please remove the fixation metal fittings and flange of the air supply inlet.



· Please attach the flange by only the screw of the right and left once again. (Please do not attach the screw of top and bottom.)

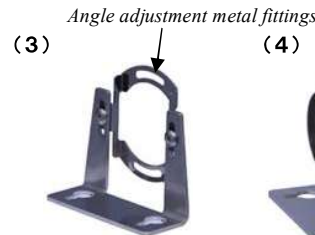

· Please attach the angle adjustment metal fittings of the belonging by the screw of the belonging to the fixation metal fittings.



· Please attach the angle adjustment metal fittings by the screw of top and bottom to the blow nozzle.

Please fix the angle adjustment metal fittings firmly after the discharge angle of the discharge slit is adjusted by loosening the screw of the top and bottom that the angle adjustment metal fittings are attached. And please use the blow nozzle.

# 2. Piping

① Please pipe the flexible hose that fit with the bore of the air supply inlet. Connection hose may come off if high pressure air is supplied. So, please pay attention to the conclusion sufficiently.

② Please plumb after exchanging the air supply inlet in accordance with the following when the air supply inlet with the screw for the pipe or air supply inlet with the flange that is suitable for JIS5K of the option was bought.

《 Air supply inlet with the screw for the pipe 》

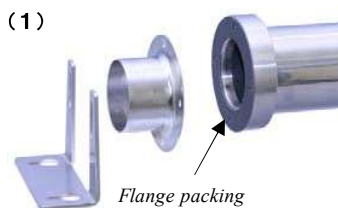

Please remove the fixation metal fittings and flange of the air supply inlet.

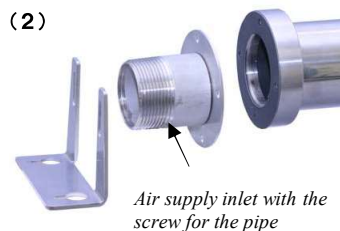

Please attach the air supply inlet with the screw for the pipe. Also, please attach even the fixation metal fittings as occasion demands.



Please pipe certainly as there is not the air leakage after attaching the air supply inlet with the screw for the pipe.

《Air supply inlet with the flange that is suitable for JIS5K 》

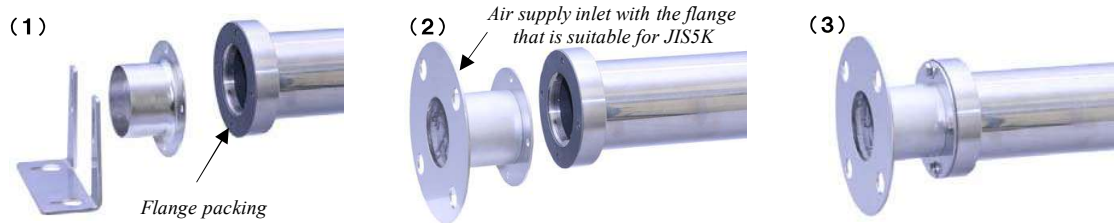

(1) Please remove the fixation metal fittings and flange of the air supply inlet.

(2) Please attach the air supply inlet with the flange that is suitable for JIS5K. Also, please attach even the fixation metal fittings as occasion demands.

(3) Please pipe certainly as there is not the air leakage after attaching the air supply inlet with the flange that is suitable for JIS5K.

### 3. Operation

- ① Please supply air, hot-air, and steam that the pressure is less than 0.1MPa and temp. is less than 350 °C.
- ② Economic using discharge air-speed is decided by the model, slit width, and slit length of the blow nozzle. Accuracy rating  $\pm 3.5\%$  (Balance of the air-speed of the right and left) may not able to be secured if the air-speed more than it was used. Please pay attention.

### 4. Dissolution and cleaning

- Inside of the blow nozzle can be disassembled, cleaned, and maintenance easily.
- ① In the case that the flange packing or O-ring is exchanged by the air leakage or deterioration.
    - Please remove the fixation metal fittings and flange after the screw of 4 places of the air supply inlet is removed. And, please exchange flange packing or O-ring. (Please purchase the flange packing or O-ring from our company.)
  - ② In the case that the dirt inside the blow nozzle and the foreign substance that accumulated inside is removed.
    - Please remove the lock screw of the slit pipe top after the top side loose bolt, fixation metal fittings, and fixation nut for a loose bolt are removed. And, please draw out the slit pipe. Please clean the main pipe and slit pipe by soft brush etc. Please wash by water in the case that dirt is awful.

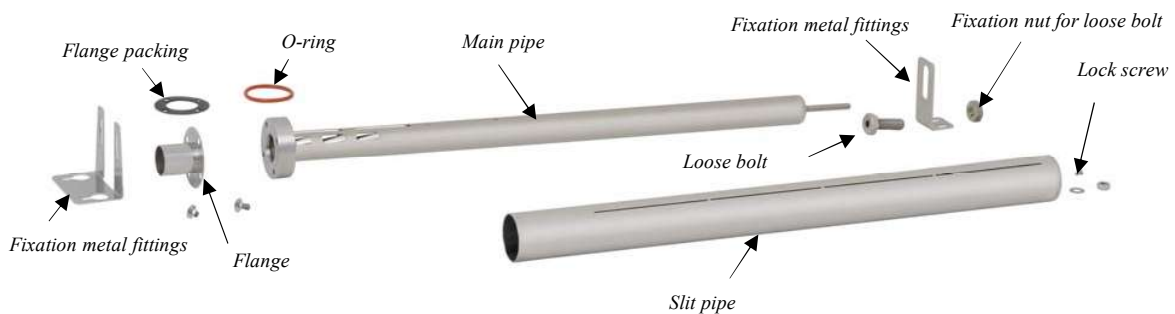

- ③ Please assemble with the reverse order after exchange and clean. Please confirm the position of the screw hole while rotating the slit pipe and please attach in the case that the lock screw is attached.